

Parks, Trails, & Open Space

Funded Projects

Overview

The Parks, Trails & Open Space Capital Improvement Program provides for the planning, design and construction of projects that include open space and park site land acquisition and park, trail and greenway development.

Highlights

1. Gradin Sports Park Development #CIPPK00001 designs and constructs additional softball/Little League baseball or soccer fields, a concession/restroom building and other associated amenities.
2. Park Master Plan Update and Concept Planning for Undeveloped Parks #CIPPK00004 will update the City's 2009 Parks and Recreation, Trails and Natural Areas Master Plan and/or develop concept plans for undeveloped parks within the City's park system.
3. Metro Local Share Park Improvements #CIPPK00006 will plan, design, and construct park or trail improvements and amenities associated with Gresham's "Local Share" component of Metro's 2019 Parks and Natural Areas bond measure.
4. ARPA/City of Gresham Investments #CIPPK00007 will use funds from the American Rescue Plan Act of 2021 to invest in Qualified Census Tract areas by promoting healthier living environments, outdoor recreation, socialization and increasing food security.
5. Additional Parks projects are included in the General Development section of the CIP.

Parks, Trails, & Open Space Expenditure Graph by Fiscal Year

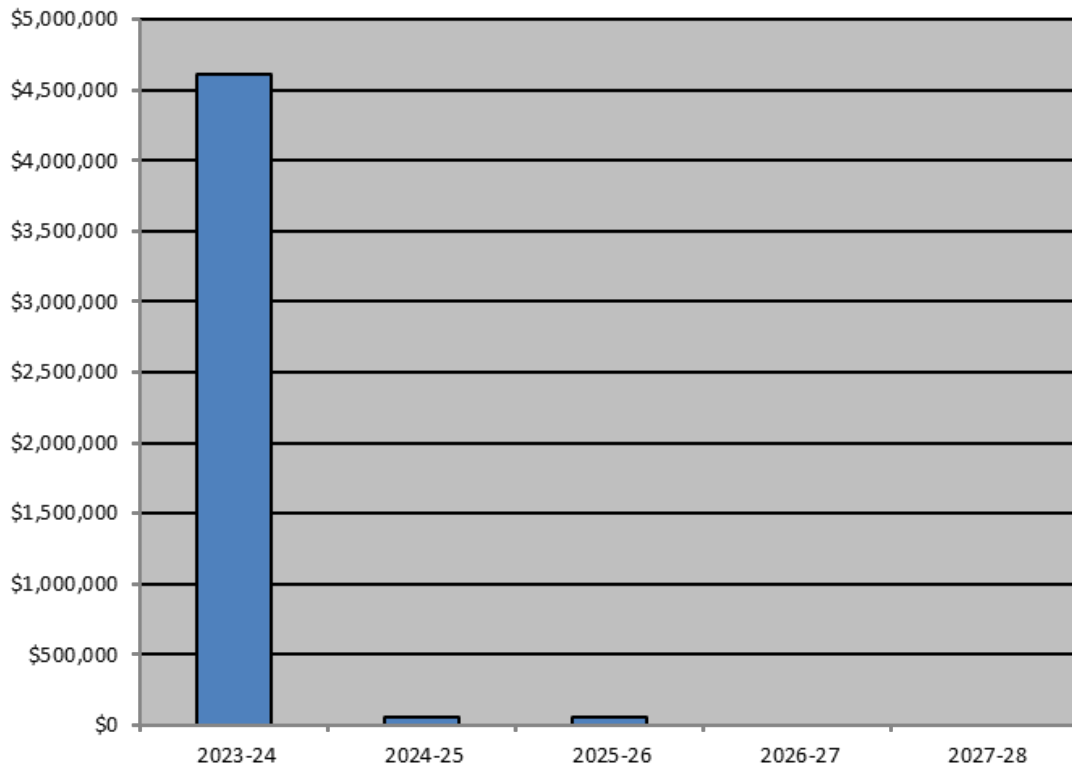

Parks, Trails, & Open Space Funded Summary									
Project	Project Name	2022-23	2023-24	2024-25	2025-26	2026-27	2027-28	Total	
CIPPK00001	Gradin Sports Park Development	5,574,620	3,183,200	0	0	0	0	8,757,820	
CIPPK00003	Development Coordination Projects	50,000	25,000	0	0	0	0	75,000	
CIPPK00004	Park Master Plan Update and Concept Planning for Undev	300,000	50,000	50,000	50,000	0	0	450,000	
CIPPK00006	Metro Local Share Park Improvements	3,422,465	1,017,535	0	0	0	0	4,440,000	
CIPPK00007	ARPA/City of Gresham Investments	689,660	0	0	0	0	0	689,660	
CIPPK00008	Civic Neighborhood Park Phase 1	2,540,507	340,796	0	0	0	0	2,881,303	
Grand Total		12,577,252	4,616,531	50,000	50,000	0	0	17,293,783	

Parks, Trails, & Open Space Funded Summary by Resource							
Description	2022-23	2023-24	2024-25	2025-26	2026-27	2027-28	Total
Other	308,600	179,100	29,100	29,100	0	0	545,900
Dev/SDC Credit	2,590,507	365,796	0	0	0	0	2,956,303
Grant	5,325,660	750,000	0	0	0	0	6,075,660
IGA	2,602,465	1,017,535	0	0	0	0	3,620,000
SDC	1,750,020	2,304,100	20,900	20,900	0	0	4,095,920
Grand Total	12,577,252	4,616,531	50,000	50,000	0	0	17,293,783

Parks, Trails, & Open Space Funded Resource Detail												
Project	Project Name	Description	2022-23	2023-24	2024-25	2025-26	2026-27	2027-28	Total			
CIPPK00001	Gradin Sports Park Development	Grant	4,000,000	750,000	0	0	0	0	4,750,000			
		Other	0	150,000	0	0	0	0	150,000			
		SDC	1,574,620	2,283,200	0	0	0	0	3,857,820			
CIPPK00001 Total		5,574,620	3,183,200	0	0	0	0	8,757,820				
CIPPK00003	Development Coordination Projects	Dev/SDC Credit	50,000	25,000	0	0	0	0	75,000			
		Other	50,000	25,000	0	0	0	0	75,000			
CIPPK00004	Park Master Plan Update and Concept Planning for Unc	Other	174,600	29,100	29,100	29,100	0	0	261,900			
		SDC	125,400	20,900	20,900	20,900	0	0	188,100			
CIPPK00004 Total		300,000	50,000	50,000	50,000	0	0	450,000				
CIPPK00006	Metro Local Share Park Improvements	Grant	695,000	0	0	0	0	0	695,000			
		IGA	2,602,465	1,017,535	0	0	0	0	3,620,000			
		Other	75,000	0	0	0	0	0	75,000			
		SDC	50,000	0	0	0	0	0	50,000			
CIPPK00006 Total		3,422,465	1,017,535	0	0	0	0	4,440,000				
CIPPK00007	ARPA/City of Gresham Investments	Grant	630,660	0	0	0	0	0	630,660			
		Other	59,000	0	0	0	0	0	59,000			
CIPPK00007 Total		689,660	0	0	0	0	0	689,660				
CIPPK00008	Civic Neighborhood Park Phase 1	Dev/SDC Credit	2,540,507	340,796	0	0	0	0	2,881,303			
		Other	2,540,507	340,796	0	0	0	0	2,881,303			
CIPPK00008 Total		12,577,252	4,616,531	50,000	50,000	0	0	17,293,783				
Grand Total												

CITY OF
GRESHAM
OREGON

FUNDED PROJECT
Parks, Trails, & Open Space

CIPPK00001: Gradin Sports Park Development

Description: This project will design additional improvements and amenities associated with the Master Plan for the Gradin Community Sports Park in south Gresham. The project is located in the Mt. Hood Neighborhood. This project is aiming to construct additional softball/Little League baseball or soccer fields, a concession/restroom building, playground, parking, street frontage, and other associated amenities. This could create a tournament-quality facility for either softball/Little League baseball or soccer. There are two awarded grants: 1) \$2,000,000 from the Oregon State Lottery Bond, and 2) \$2,000,000 from the federal Consolidated Appropriations Act of 2022. A third grant application is being submitted for a \$750,000 Local Government Grant Program administered by Oregon State Parks. Other funds of \$150,000 in sports field fees will also be used. This project is related to #723400. SDC project #20.

Justification: This multi-use sports complex is needed to help meet the recreation and service needs of the community.

Type of Project: Design and construction of new community park amenities.

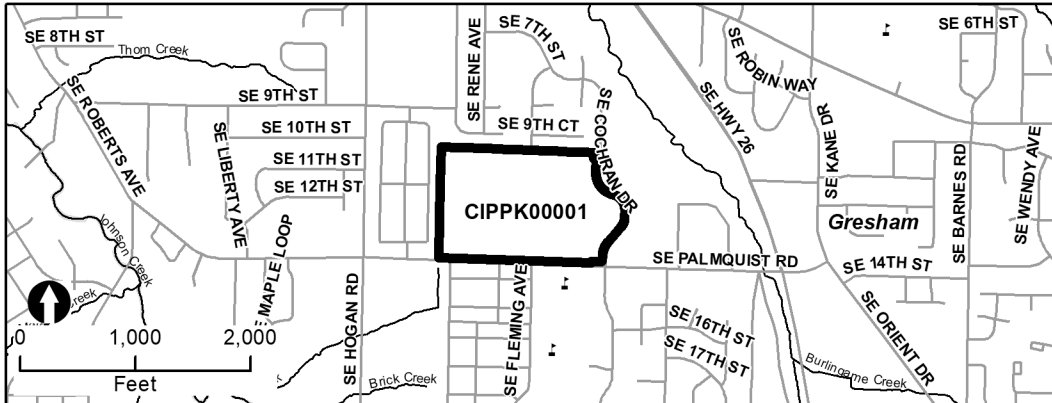

Estimated Dollars:

Funds	Description	2022-23	2023-24	2024-25	2025-26	2026-27	2027-28	Total
Resources	Other	0	150,000	0	0	0	0	150,000
	Grant	4,000,000	750,000	0	0	0	0	4,750,000
	SDC	1,574,620	2,283,200	0	0	0	0	3,857,820
Resources Total		5,574,620	3,183,200	0	0	0	0	8,757,820
Expenses	Design/Const Admin	500,000	75,000	0	0	0	0	575,000
	Construction	4,390,020	2,717,300	0	0	0	0	7,107,320
	Admin (14%)	684,600	390,900	0	0	0	0	1,075,500
Expenses Total		5,574,620	3,183,200	0	0	0	0	8,757,820

FUNDED PROJECT
Parks, Trails, & Open Space

CIPPK00003: Development Coordination Projects

Description: This project funding will be used to leverage park revenue with new development projects or other projects resulting in park and path/trail improvements beyond what either the new development or City resources could have accomplished alone. This project may provide systems development charge credits to developers for certain identified improvements.

Justification: Development projects often trigger a need for certain improvements that are not within the scope of the project, but need to be done to accommodate the park and path/trail impacts. This project creates a funding base to complement the developer's contribution and to accomplish needed improvements.

Type of Project: Construction of facilities and utilities for growth.



Estimated Dollars:

Funds	Description	2022-23	2023-24	2024-25	2025-26	2026-27	2027-28	Total
Resources	Dev/SDC Credit	50,000	25,000	0	0	0	0	75,000
Resources Total		50,000	25,000	0	0	0	0	75,000
Expenses	Construct/Reimburse	50,000	25,000	0	0	0	0	75,000
Expenses Total		50,000	25,000	0	0	0	0	75,000

FUNDED PROJECT
Parks, Trails, & Open Space

CIPPK00004: Park Master Plan Update and Concept Planning for Undeveloped Parks

Description: This project will update the City’s 2009 Parks and Recreation, Trails and Natural Areas Master Plan and/or develop concept plans for undeveloped parks within the City’s park system.

Justification: The City’s Parks and Recreation, Trails and Natural Areas Master Plan is over 10 years old and needs to be updated to reflect the process made since 2009 and accurately depict the community’s desires for the buildout of the remaining park system in Gresham. Concept plans will identify park amenities and costs for the development of a wide range of active and passive recreation opportunities within the 6 undeveloped park sites in Gresham.

Type of Project: Master planning and concept planning for growth of the parks system.

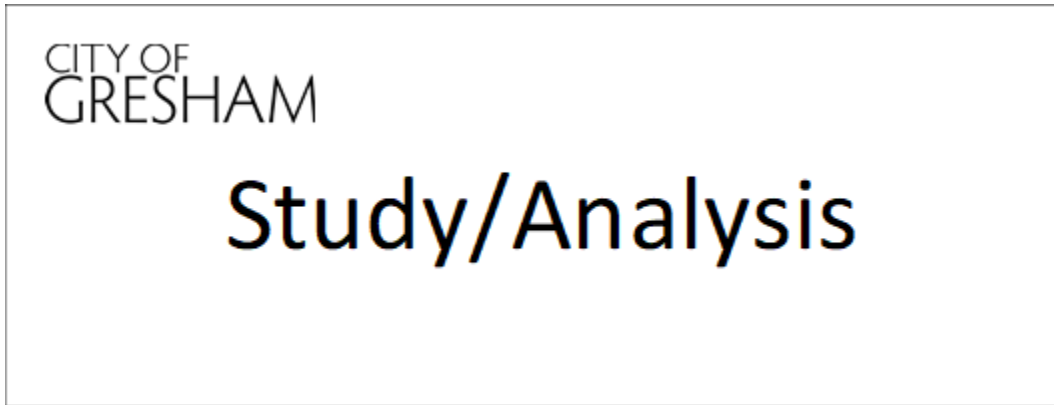

Estimated Dollars:

Funds	Description	2022-23	2023-24	2024-25	2025-26	2026-27	2027-28	Total
Resources	Other	174,600	29,100	29,100	29,100	0	0	261,900
	SDC	125,400	20,900	20,900	20,900	0	0	188,100
Resources Total		300,000	50,000	50,000	50,000	0	0	450,000
Expenses	Design/Const Admin	263,200	43,900	43,900	43,900	0	0	394,900
	Admin (14%)	36,800	6,100	6,100	6,100	0	0	55,100
Expenses Total		300,000	50,000	50,000	50,000	0	0	450,000

FUNDED PROJECT
Parks, Trails, & Open Space

CIPPK00006: Metro Local Share Park Improvements

Description: This project will plan, design, and construct park or trail improvements and amenities associated with Gresham’s “Local Share” component of Metro’s 2019 Parks and Natural Areas bond measure. This project will be associated with an IGA between Metro and the City of Gresham that will specify the projects the City of Gresham will construct with its Local Share dollars from the bond.

Justification: This project will help provide access to nature for the community.

Type of Project: Design and construction of new park or trail amenities.



Estimated Dollars:

Funds	Description	2022-23	2023-24	2024-25	2025-26	2026-27	2027-28	Total
Resources	Other	75,000	0	0	0	0	0	75,000
	Grant	695,000	0	0	0	0	0	695,000
	IGA	2,602,465	1,017,535	0	0	0	0	3,620,000
	SDC	50,000	0	0	0	0	0	50,000
Resources Total		3,422,465	1,017,535	0	0	0	0	4,440,000
Expenses	Design/Const Admin	350,000	0	0	0	0	0	350,000
	Construction	2,972,665	987,935	0	0	0	0	3,960,600
	Admin (3%)	99,800	29,600	0	0	0	0	129,400
Expenses Total		3,422,465	1,017,535	0	0	0	0	4,440,000

FUNDED PROJECT
Parks, Trails, & Open Space

CIPPK00007: ARPA/City of Gresham Investments

Description: This project will use funds from the American Rescue Plan Act of 2021 to invest in Qualified Census Tract areas to, 1) construct a multi-sport surface and renovate a basketball surface in West Gresham, and, if construction bids are favorable, renovate basketball and tennis courts at other Gresham parks, 2) complete the Americans with Disabilities Act (ADA) capital assessment of all Gresham parks and construct the first fully ADA accessible playground infrastructure in Gresham, and 3) construct, in partnership with a community-based organization, a new community garden in the Rockwood neighborhood.

Justification: These investments address health disparities and the social determinants of health by promoting healthier living environments and outdoor recreation and socialization to mitigate the spread of COVID-19 and increase food security in an area that has lacked fresh, healthy options.

Type of Project: Construction and renovation of neighborhood park facilities.



Estimated Dollars:

Funds	Description	2022-23	2023-24	2024-25	2025-26	2026-27	2027-28	Total
Resources	Other	59,000	0	0	0	0	0	59,000
	Grant	630,660	0	0	0	0	0	630,660
Resources Total		689,660	0	0	0	0	0	689,660
Expenses	Design/Const Admin	100,000	0	0	0	0	0	100,000
	Construction	504,960	0	0	0	0	0	504,960
	Admin (14%)	84,700	0	0	0	0	0	84,700
Expenses Total		689,660	0	0	0	0	0	689,660

FUNDED PROJECT
Parks, Trails, & Open Space

CIPPK00008: Civic Neighborhood Park Phase 1

Description: This project reflects the City’s potential obligation to reimburse a developer for construction of park infrastructure related to the Civic Neighborhood Plan Area. The project is located in the Northwest Neighborhood District. This project is related to #CIPPK00005 and #725000. SDC project #65.

Justification: Development is needed to provide a wide range of active and passive recreation opportunities for citizens at their nearby neighborhood park.

Type of Project: Design and/or construction of neighborhood park facilities for growth.

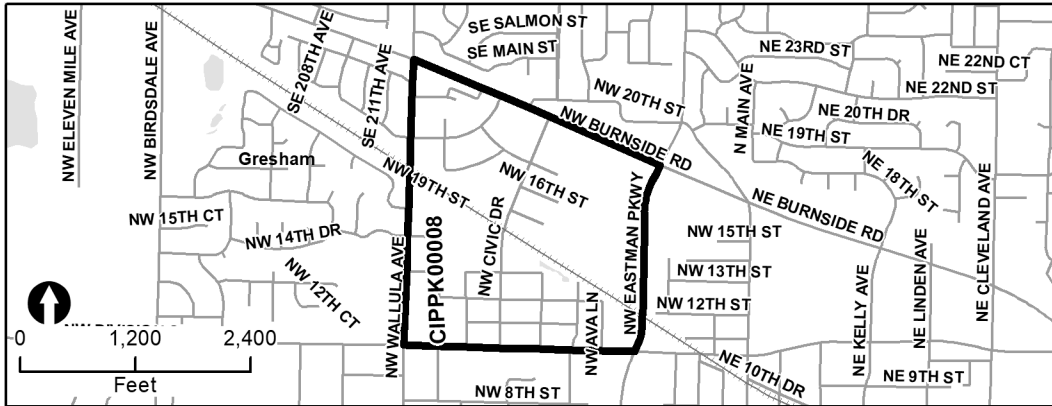

Estimated Dollars:

Funds	Description	2022-23	2023-24	2024-25	2025-26	2026-27	2027-28	Total
Resources	Dev/SDC Credit	2,540,507	340,796	0	0	0	0	2,881,303
Resources Total		2,540,507	340,796	0	0	0	0	2,881,303
Expenses	Construct/Reimburse	2,540,507	340,796	0	0	0	0	2,881,303
Expenses Total		2,540,507	340,796	0	0	0	0	2,881,303

Parks, Trails, & Open Space Unfunded and Future Summary								
Project	Project Name	2022-23	2023-24	2024-25	2025-26	2026-27	2027-28	Total
703200	SE Community Park Master Plan	0	0	0	0	0	0	107,102
705000	SW Community Park Development	0	0	0	0	0	0	16,659,091
707800	Pat Pfeifer Park Phase III	0	0	0	0	0	0	3,407,603
710900	Southwest Neighborhood Park	0	0	0	0	0	0	3,417,738
711200	ADA Accessibility Rehabilitation	0	0	0	0	0	0	184,679
711900	Zimmerman Heritage Farm Community Park	0	0	0	0	0	0	3,783,012
713700	South Central Neighborhood Park Dev.	0	0	0	0	0	0	3,008,571
715800	East Gresham Neighborhood Park	0	0	0	0	0	0	3,586,873
722000	SW Community Park Master Plan	0	0	0	0	0	0	107,102
722100	Southeast Neighborhood Park	0	0	0	0	0	0	4,215,066
722200	Jenne Butte Neighborhood Park Master Plan	0	0	0	0	0	0	81,423
722300	Jenne Butte Neighborhood Park Development	0	0	0	0	0	0	4,258,438
722400	Downtown Neighborhood Park #1	0	0	0	0	0	0	4,102,438
722500	Gresham Paths	0	0	0	0	0	0	2,384,336
722501	Gresham Soft Trails	0	0	0	0	0	0	10,598,388
722600	Rockwood Neighborhood Park	0	0	0	0	0	0	3,350,846
722700	Pat Pfeifer Park Irrigation	0	0	0	0	0	0	50,000
723300	Skate Park Future Phases	0	0	0	0	0	0	2,280,000
723400	Sports Park Development	0	0	0	0	0	0	33,157,969
723500	Arts Center	0	0	0	0	0	0	16,480,000
723600	SE Community Park Development	0	0	0	0	0	0	9,203,656
723700	Main City Park Improvements Future	0	0	0	0	0	0	9,387,650
723800	Hogan Butte Nature Park Development - Phase 2	0	0	0	0	0	0	3,758,017
724700	Civic Neighborhood Station Plaza	0	0	0	0	0	0	1,346,602
724800	Nadaka Nature Park	0	0	0	0	0	0	37,579
724900	Columbia View Neighborhood Park	0	0	0	0	0	0	4,794,902
725000	Civic Neighborhood Park Phase 2	0	0	0	0	0	0	4,102,438
725100	Rockwood Soccer/Futsal Courts	0	0	0	0	0	0	200,425
725200	Downtown Neighborhood Park #2 - East	0	0	0	0	0	0	4,102,438
CIPPK00002	Vance Neighborhood Park	0	0	0	0	0	0	150,000
CIPPK00005	Civic Neighborhood Development - 1996 Agreement	0	0	0	0	0	0	799,700
Grand Total		0	0	0	0	0	0	153,104,082

CITY OF
GRESHAM
OREGON

**UNFUNDED and FUTURE PROJECT
Parks, Trails, & Open Space**

703200: SE Community Park Master Plan

Description: This project will complete the master planning and design for the 16.13-acre, undeveloped community park site in southeast Gresham. The project is located in the Kelly Creek Neighborhood District. This project is related to #723600. SDC project #4.

Justification: The master plan will identify park amenities and costs for the development of a wide range of active and passive recreation opportunities for all Gresham residents.

Type of project: Master planning and design of a community park for growth.

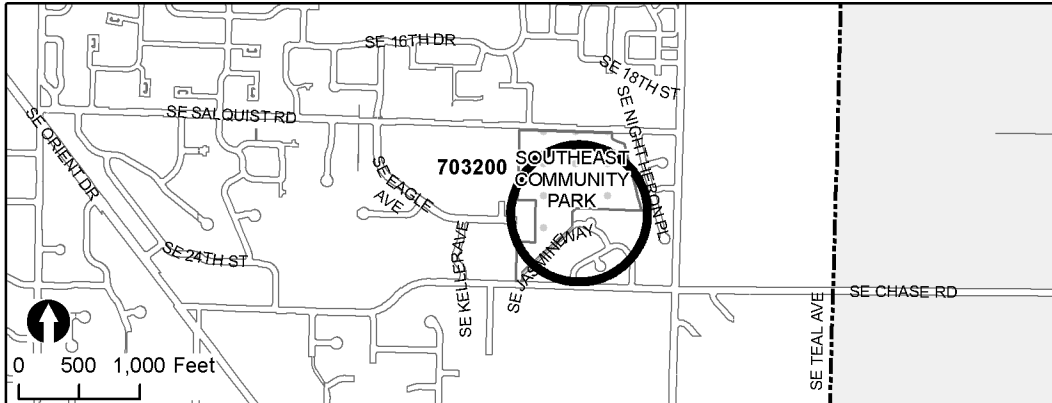

Estimated Dollars:

Funds	Description	Total
Resources	Other	59,877
	SDC	47,225
Resources Total		107,102
Expenses	Design/Const Admi	93,949
	Admin (14%)	13,153
Expenses Total		107,102

**UNFUNDED and FUTURE PROJECT
Parks, Trails, & Open Space**

705000: SW Community Park Development

Description: This project will construct recreation facilities identified in the master plan for the 34.11-acre undeveloped community park in southwest Gresham. The project is located in the Centennial Neighborhood District. This project is related to #722000. SDC project #5.

Justification: Development is needed to provide a wide range of active and passive recreation opportunities for all Gresham residents, such as natural areas, performance spaces, playing fields for organized sports, trails, and group picnic areas.

Type of Project: Construction of facilities and utilities for growth.

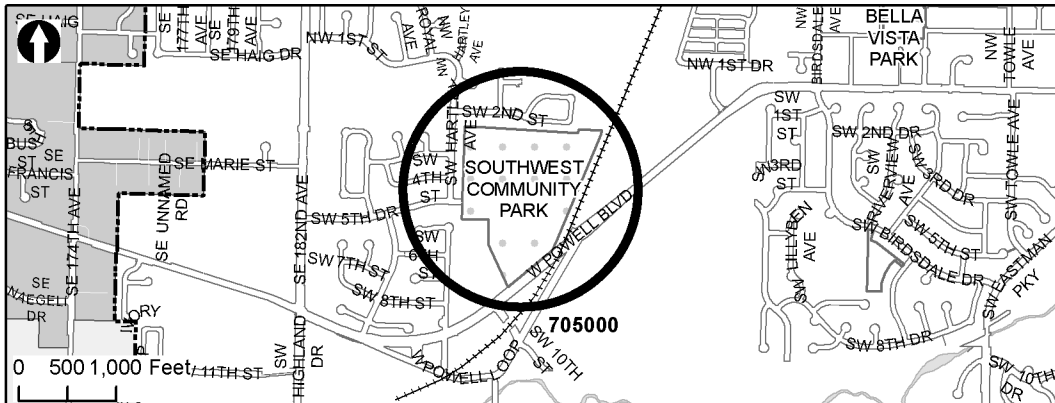

Estimated Dollars:

Funds	Description	Total
Resources	Other	9,321,626
	SDC	7,337,465
Resources Total		16,659,091
Expenses	Design/Const Admi	438,744
	Construction	14,174,494
	Admin (14%)	2,045,853
Expenses Total		16,659,091

**UNFUNDED and FUTURE PROJECT
Parks, Trails, & Open Space**

707800: Pat Pfeifer Park Phase III

Description: This project will provide additional recreation facilities to complete development of the 13.39-acre partially developed community park in west Gresham. The project is located in the Rockwood Neighborhood District. This project is related to #711200 and #722700. SDC project #6.

Justification: Development is needed to provide a wide range of active and passive recreation opportunities for all Gresham residents, such as performance spaces, playing fields for organized sports, and group picnic areas.

Type of Project: Construction of additional park facilities at a partially developed community park for growth.

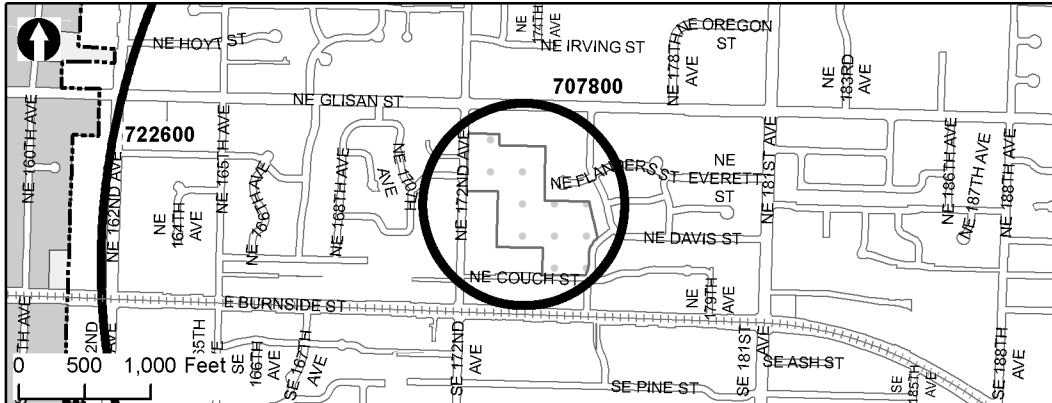

Estimated Dollars:

Funds	Description	Total
Resources	Other	1,906,721
	SDC	1,500,882
Resources Total		3,407,603
Expenses	Design/Const Admi	532,693
	Construction	2,456,432
	Admin (14%)	418,478
Expenses Total		3,407,603

**UNFUNDED and FUTURE PROJECT
Parks, Trails, & Open Space**

710900: Southwest Neighborhood Park

Description: This project will acquire land, prepare the master plan, design and construct a 2.5-acre neighborhood park in south Gresham. The project is located in the Gresham Butte Neighborhood District. SDC project #7.

Justification: Acquisition and development are needed to provide a wide range of active and passive recreation opportunities for citizens at their nearby neighborhood park.

Type of Project: Construction of neighborhood park for growth.

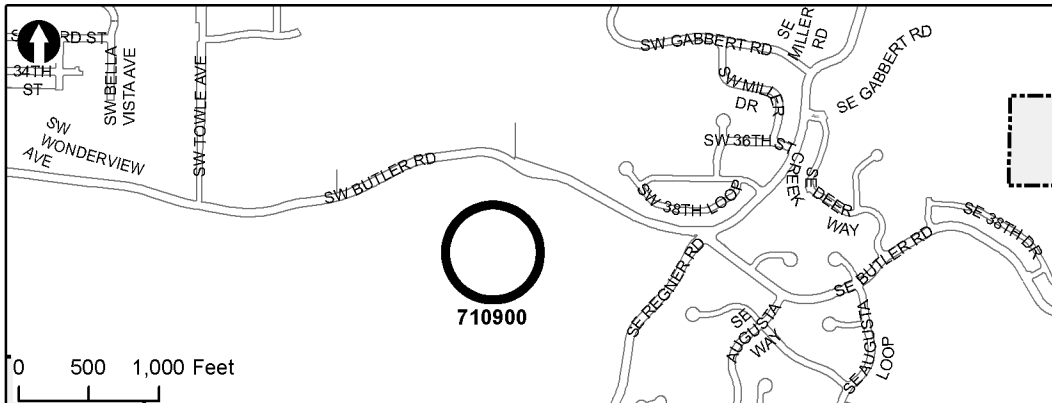

Estimated Dollars:

Funds	Description	Total
Resources	Other	1,512,751
	SDC	1,904,987
Resources Total		3,417,738
Expenses	Design/Const Admi	93,949
	Property Acq	818,483
	Construction	2,085,583
	Admin (14%)	419,723
Expenses Total		3,417,738

**UNFUNDED and FUTURE PROJECT
Parks, Trails, & Open Space**

711200: ADA Accessibility Rehabilitation

Description: This project will renovate existing park, trail and open space facilities to meet the federally mandated Americans with Disabilities Act of 1992 (ADA) requirements. The required access route, curb, ramp, handrail, signage, parking, playground, drinking fountain, and picnic table improvements will be constructed to provide the community with accessible recreation opportunities for all age groups. Renovations to meet ADA requirements will occur at the following parks: Aspen Highlands, Bella Vista, Butler Creek, Columbia View, Davis, Hall, Kane Road, Kirk, North Gresham, Pat Pfeifer, Rockwood Central and Thom Park. Renovations will also occur along the Butler Creek Greenway trail and the Springwater Trail. This project is related to #707800 and #724900.

Justification: The City has been mandated to provide accessible recreation opportunities for people with disabilities.

Type of Project: Repair and rehabilitation of facilities in various parks.



Estimated Dollars:	Funds	Description	Total
	Resources	Grant	100,000
		Operating	84,679
	Resources Total		184,679
	Expenses	Design/Const Admin	20,000
		Construction	141,999
		Admin (14%)	22,680
	Expenses Total		184,679

**UNFUNDED and FUTURE PROJECT
Parks, Trails, & Open Space**

711900: Zimmerman Heritage Farm Community Park

Description: This project will design and construct community park facilities on this 5.97 acre historic property. The project will be in cooperation with the Multnomah County Historic Society, who owns the Zimmerman House, while the City of Gresham owns the underlying property. The Zimmerman Heritage Farm master plan was adopted in 1988 and may require an update. The project is located in the Wilkes East Neighborhood District. SDC project #8.

Justification: The project will provide passive recreation facilities and educational opportunities for the community to learn about Gresham’s history of agriculture.

Type of Project: Construction of additional park facilities at a partially developed community park for growth.

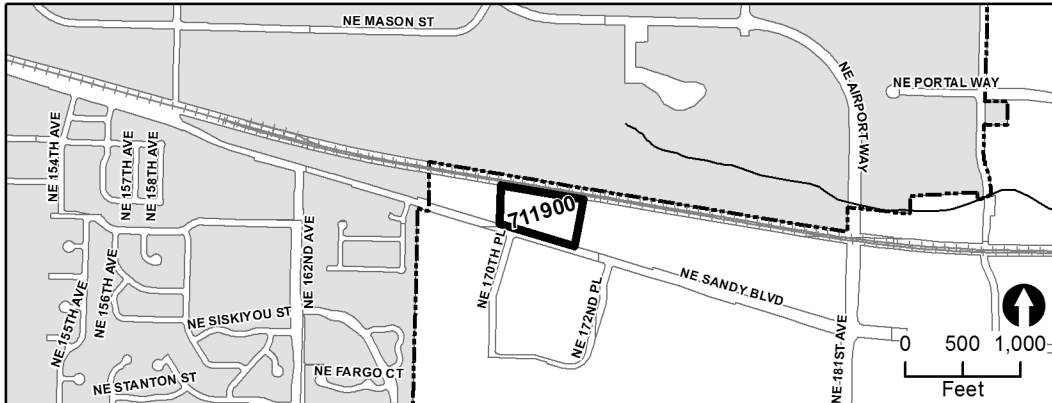

Estimated Dollars:

Funds	Description	Total
Resources	Other	2,116,779
	SDC	1,666,233
Resources Total		3,783,012
Expenses	Design/Const Admi	82,411
	Construction	3,236,021
	Admin (14%)	464,580
Expenses Total		3,783,012

**UNFUNDED and FUTURE PROJECT
Parks, Trails, & Open Space**

713700: South Central Neighborhood Park Development

Description: This project will master plan, design and construct a 2.91-acre neighborhood park at this undeveloped site in south Gresham. The project is located in the Gresham Butte Neighborhood District. SDC project #9.

Justification: Development is needed to provide a wide range of active and passive recreation opportunities for citizens at their nearby neighborhood park.

Type of Project: Master plan, design and construction of a neighborhood park for growth.

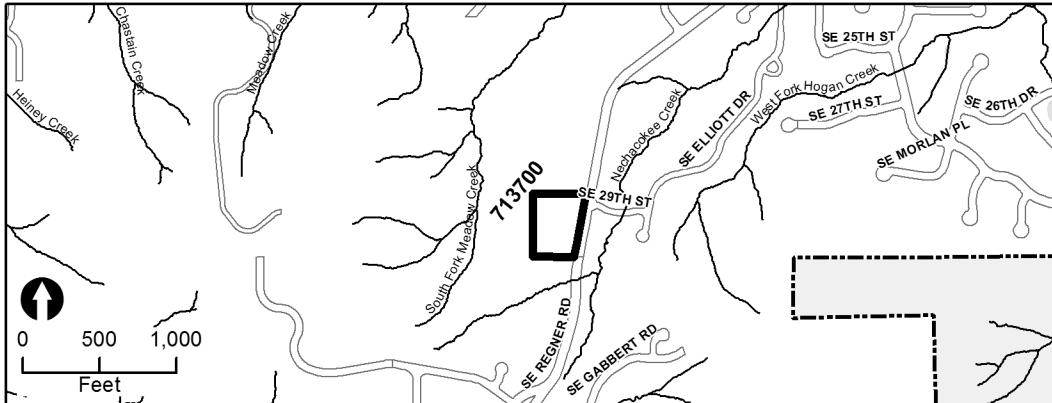

Estimated Dollars:

Funds	Description	Total
Resources	Other	1,750,971
	SDC	1,257,600
Resources Total		3,008,571
Expenses	Design/Const Admi	93,949
	Construction	2,545,148
	Admin (14%)	369,474
Expenses Total		3,008,571

**UNFUNDED and FUTURE PROJECT
Parks, Trails, & Open Space**

715800: East Gresham Neighborhood Park

Description: This project will master plan, design, and construct a 5.53-acre neighborhood park in southeast Gresham. This project is located in the Powell Valley Neighborhood District. SDC project #10.

Justification: Development is needed to provide a wide range of active and passive recreation opportunities for citizens at their nearby neighborhood park.

Type of Project: Master plan, design and construction of a neighborhood park for growth.

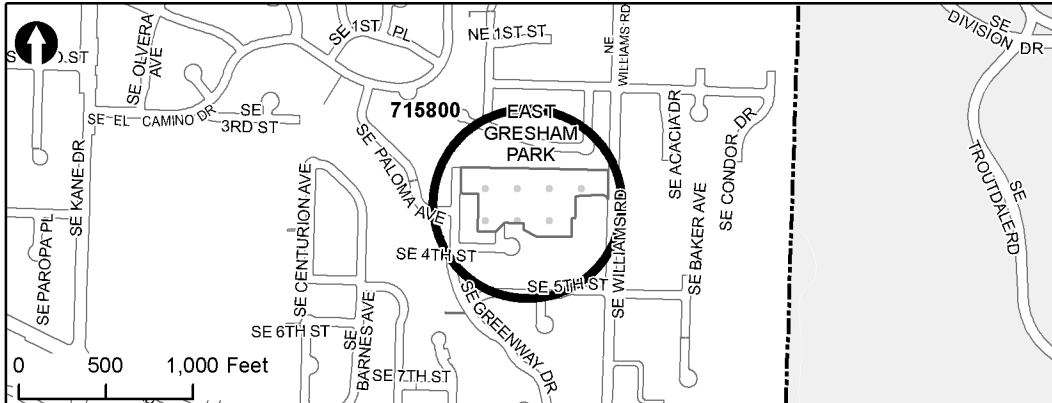

Estimated Dollars:

Funds	Description	Total
Resources	Other	2,087,540
	SDC	1,499,333
Resources Total		3,586,873
Expenses	Design/Const Admi	125,265
	Construction	3,021,115
	Admin (14%)	440,493
Expenses Total		3,586,873

**UNFUNDED and FUTURE PROJECT
Parks, Trails, & Open Space**

722000: Southwest Community Park Master Plan

Description: This project will master plan and design a 34.11-acre community park at this undeveloped site in southwest Gresham. The project is located in the Centennial Neighborhood District. This project is related to #705000. SDC project #5.

Justification: The master plan will identify park amenities and costs for the development of a wide range of active and passive recreation opportunities for all Gresham residents.

Type of Project: Master planning and design of a community park for growth.

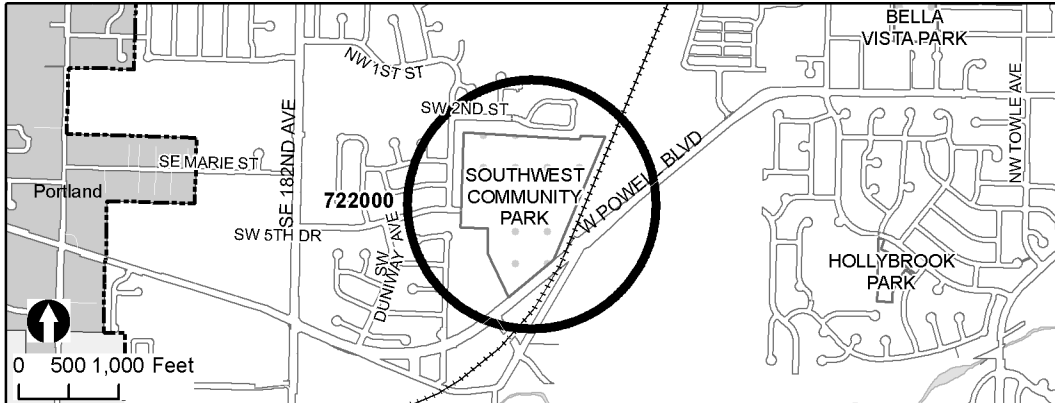

Estimated Dollars:

Funds	Description	Total
Resources	Other	59,877
	SDC	47,225
Resources Total		107,102
Expenses	Design/Const Admi	93,949
	Admin (14%)	13,153
Expenses Total		107,102

**UNFUNDED and FUTURE PROJECT
Parks, Trails, & Open Space**

722100: Southeast Neighborhood Park

Description: This project will master plan, design and construct a 6.53-acre neighborhood park at this undeveloped site in southeast Gresham. The project is located in the Kelly Creek Neighborhood District. SDC project #14.

Justification: Development is needed to provide a wide range of active and passive recreation opportunities for citizens at their nearby neighborhood park.

Type of Project: Master plan, design and construction of a neighborhood park for growth.

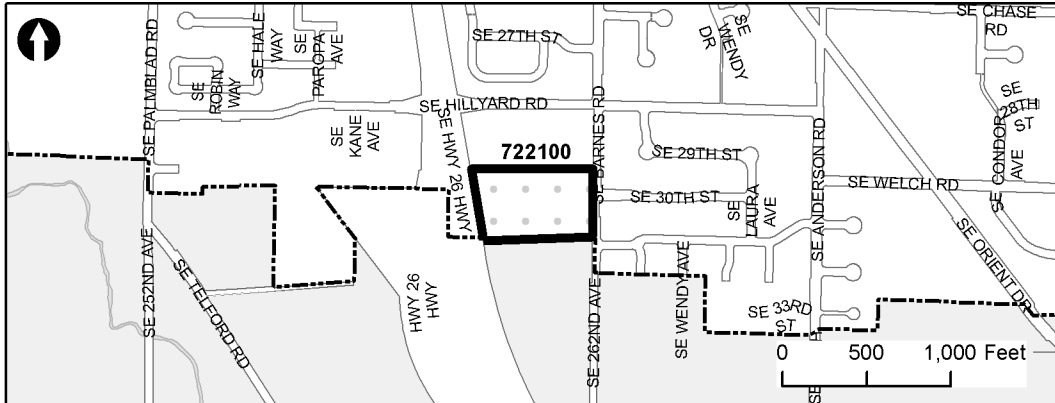

Estimated Dollars:

Funds	Description	Total
Resources	Other	2,453,146
	SDC	1,761,920
Resources Total		4,215,066
Expenses	Design/Const Admi	125,265
	Construction	3,572,161
	Admin (14%)	517,640
Expenses Total		4,215,066

**UNFUNDED and FUTURE PROJECT
Parks, Trails, & Open Space**

722200: Jenne Butte Neighborhood Park Master Plan

Description: This project will master plan and design a 6.73-acre neighborhood park at this undeveloped site in southwest Gresham. The project is located in the Southwest Neighborhood District. This project is related to #722300. SDC project #15.

Justification: The master plan will identify park amenities and costs for the development of a wide range of active and passive recreation opportunities for citizens at their nearby neighborhood park.

Type of Project: Master planning and design of a neighborhood park for growth.

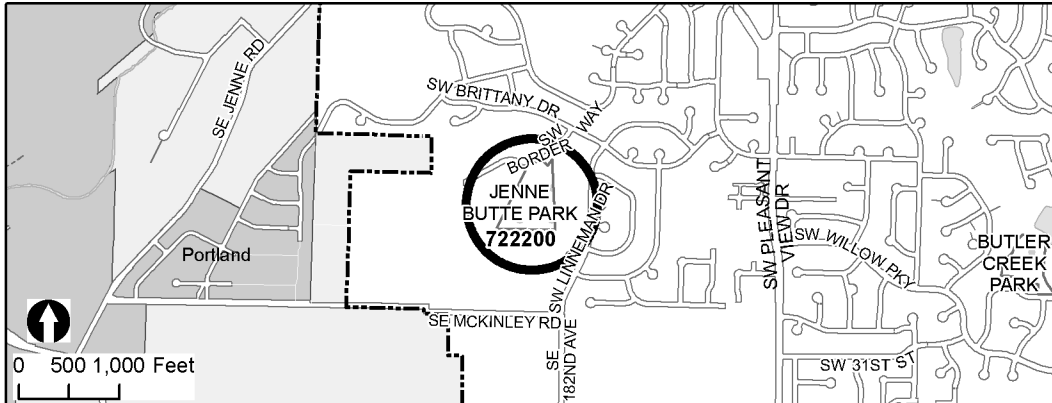

Estimated Dollars:

Funds	Description	Total
Resources	Other	34,035
	SDC	47,388
Resources Total		81,423
Expenses	Design/Const Admi	71,424
	Admin (14%)	9,999
Expenses Total		81,423

**UNFUNDED and FUTURE PROJECT
Parks, Trails, & Open Space**

722300: Jenne Butte Neighborhood Park Development

Description: This project will construct a 6.73-acre neighborhood park at this undeveloped site in southwest Gresham. The project is located in the Southwest Neighborhood District. This project is related to #722200. SDC project #15.

Justification: Development is needed to provide a wide range of active and passive recreation opportunities for citizens at their nearby neighborhood park.

Type of Project: Construction of neighborhood park facilities for growth.

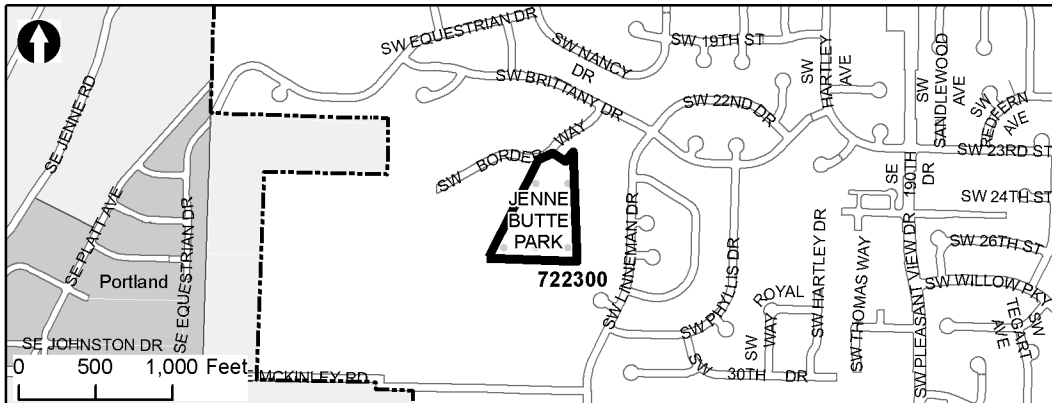

Estimated Dollars:

Funds	Description	Total
Resources	Other	2,491,740
	SDC	1,766,698
Resources Total		4,258,438
Expenses	Design/Const Admi	53,842
	Construction	3,681,630
	Admin (14%)	522,966
Expenses Total		4,258,438

**UNFUNDED and FUTURE PROJECT
Parks, Trails, & Open Space**

722400: Downtown Neighborhood Park #1

Description: This project will acquire land, master plan, design and construct an up to 2-acre neighborhood park in the Downtown plan boundary. The project is located in the Central City Neighborhood District. SDC project #66.

Justification: Development is needed to provide a wide range of active and passive recreation opportunities for citizens at their nearby neighborhood park.

Type of Project: Acquisition, master plan, design and construction of a neighborhood park for growth.

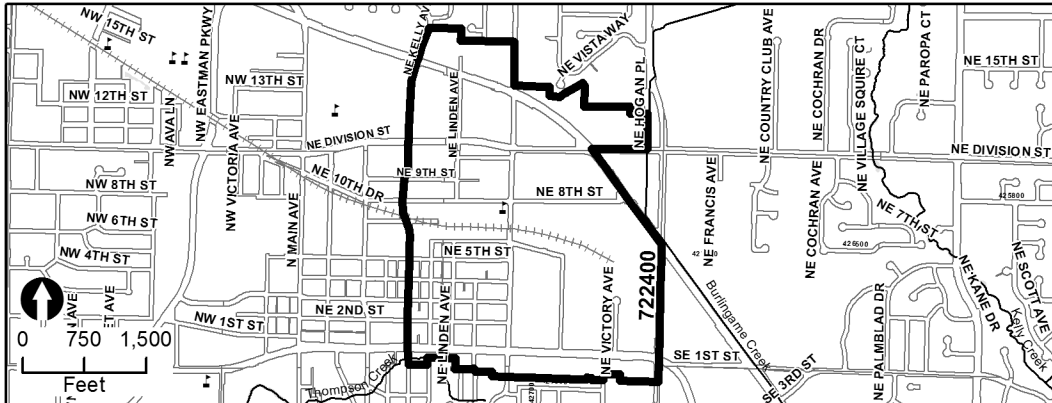

Estimated Dollars:

Funds	Description	Total
Resources	Other	1,221,137
	SDC	2,881,301
Resources Total		4,102,438
Expenses	Design/Const Admi	93,949
	Property Acq	2,004,245
	Construction	1,500,436
	Admin (14%)	503,808
Expenses Total		4,102,438

**UNFUNDED and FUTURE PROJECT
Parks, Trails, & Open Space**

722500: Gresham Paths

Description: This project will acquire easements and/or right-of-ways, design and construct the following: 1) approximately 0.88 miles of off-road paths and associated infrastructure identified in the Gresham Trails Master Map adopted as Appendix J of the Parks and Recreation Trails and Natural Areas Master Plan; SDC project #43 and #77, and 2) approximately 0.38 miles of the incomplete Wy'East Path between NE 8th Street and NE Hogan Drive; SDC project #60.

Justification: Path and trail activities are the most popular form of recreation among park users in Gresham. This project provides opportunities for trail-related recreation; reduces auto-dependency by providing safe off-street, non-motorized neighborhood transportation connections; and connects to community open space.

Type of Project: Acquisition, design and construction of off-road paths for growth.



Estimated Dollars:	Funds	Description	Total
	Resources	Other	1,021,763
		SDC	1,362,573
	Resources Total		2,384,336
	Expenses	Design/Const Admi	367,204
		Property Acq	500,306
		Construction	1,224,012
		Admin (14%)	292,814
	Expenses Total		2,384,336

**UNFUNDED and FUTURE PROJECT
Parks, Trails, & Open Space**

722501 : Gresham Soft Trails

Description: The project will acquire easements and/or right-of-ways, design and construct approximately 15.61 miles of soft surface trails and associated infrastructure identified in the Gresham Trails Master Map adopted as Appendix J of the Parks and Recreation Trails and Natural Areas Master Plan. This project does not include off-road paths in Gresham (see #722500) or soft trails in the Pleasant Valley or Springwater plan districts. SDC project #s: 40, 41, 45, 51, 52, 53, 78.

Justification: Path and trail activities are the most popular form of recreation among park users in Gresham. This project provides opportunities for trail-related recreation; reduces auto-dependency by providing safe off-street, non-motorized neighborhood transportation connections; and connects to community open space.

Type of Project: Acquisition, design and construction of soft surface trails for growth.



Estimated Dollars:	Funds	Description	Total
	Resources	Other	4,541,741
		SDC	6,056,647
	Resources Total		10,598,388
	Expenses	Design/Const Admi	2,060,557
		Property Acq	367,754
		Construction	6,868,520
		Admin (14%)	1,301,557
	Expenses Total		10,598,388

**UNFUNDED and FUTURE PROJECT
Parks, Trails, & Open Space**

722600: Rockwood Neighborhood Park

Description: This project will acquire land, master plan, design and construct an approximately 2-acre neighborhood park in the Rockwood Plan District. SDC project #70.

Justification: Development is needed to provide a wide range of active and passive recreation opportunities for citizens at their nearby neighborhood park.

Type of Project: Acquisition, master plan, design and construction of a neighborhood park for growth.

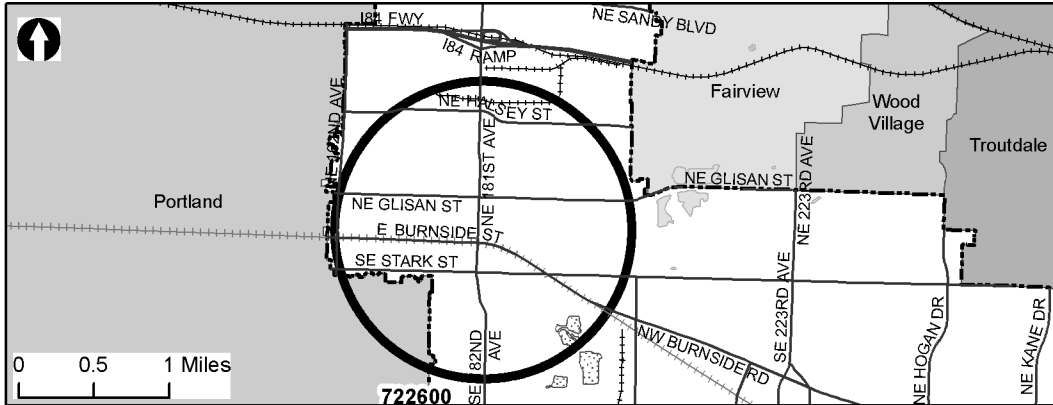

Estimated Dollars:

Funds	Description	Total
Resources	Other	1,221,137
	SDC	2,129,709
Resources Total		3,350,846
Expenses	Design/Const Admi	93,949
	Property Acq	1,098,818
	Construction	1,746,572
	Admin (14%)	411,507
Expenses Total		3,350,846

**UNFUNDED and FUTURE PROJECT
Parks, Trails, & Open Space**

722700: Pat Pfiefer Park Irrigation

Description: This project will install irrigation to serve the last two non-irrigated fields in the park. The project is located in the Rockwood Neighborhood District. This will increase playability and enhance the level of service for the user groups.

Justification: Complete the irrigation system at Pat Pfiefer Park.

Type of Project: Design and Construction

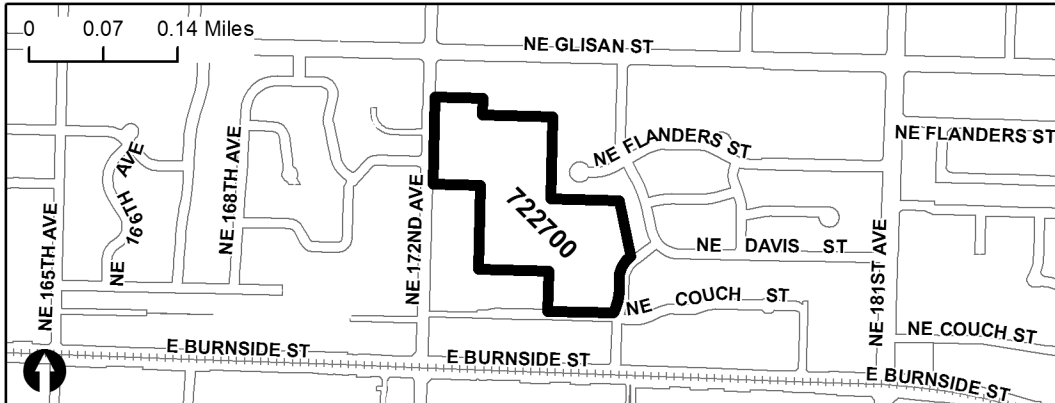

Estimated Dollars:

Funds	Description	Total
Resources	Grant	50,000
Resources Total		50,000
Expenses	Design/Const Admin	15,000
	Construction	28,860
	Admin (14%)	6,140
Expenses Total		50,000

**UNFUNDED and FUTURE PROJECT
Parks, Trails, & Open Space**

723300: Skate Park Future Phases

Description: This project will construct additional improvements to the Skate Park. These improvements are broken into two phases. The first phase is additional skating features, ramps and bowls. The second phase is a fabric cover for the skate park. The project is located in the Central City Neighborhood District.

Justification: Provide recreational amenities for all community members.

Type of Project: Construct additional park improvements at an existing community park.

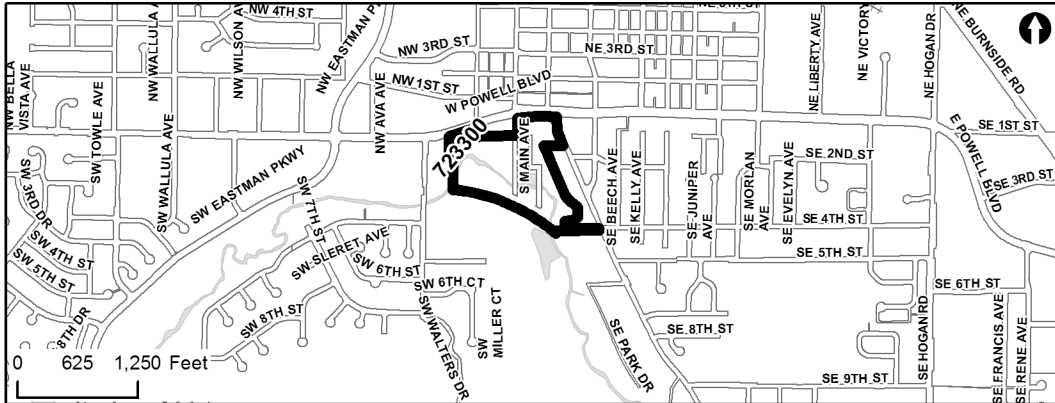

Estimated Dollars:

Funds	Description	Total
Resources	Other	2,280,000
Resources Total		2,280,000
Expenses	Design/Const Admin	400,000
	Construction	1,600,000
	Admin (14%)	280,000
Expenses Total		2,280,000

**UNFUNDED and FUTURE PROJECT
Parks, Trails, & Open Space**

723400: Sports Park Development

Description: This project will complete the construction at the Gradin Community Sports Park in south Gresham. This includes the building of the community center, skate park, sports fields and all other elements associated with the Master Plan. The project is located in the Mt. Hood Neighborhood District. This project is related to #CIPPK00001. SDC project #20.

Justification: This multi-use facility is needed to help meet the recreation facility and service needs of the community.

Type of Project: Construction of additional community park improvements for growth.

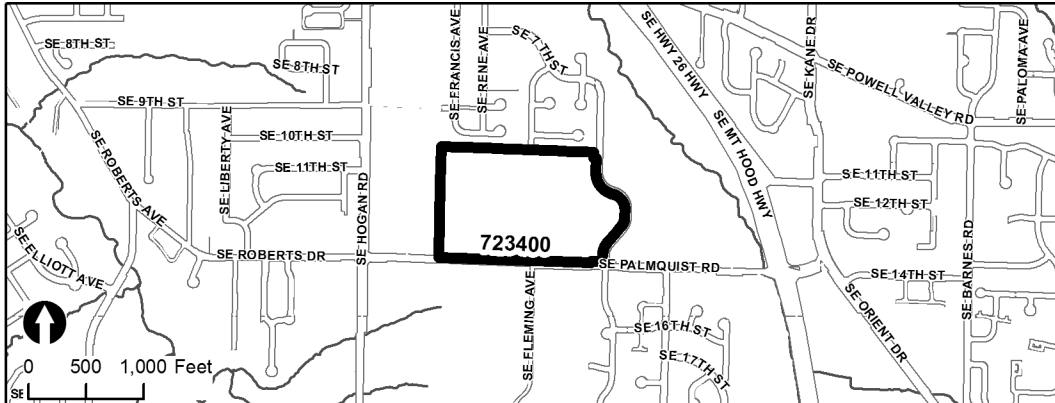

Estimated Dollars:

Funds	Description	Total
Resources	Other	18,553,550
	SDC	14,604,419
Resources Total		33,157,969
Expenses	Design/Const Admi	2,609,914
	Construction	26,476,023
	Admin (14%)	4,072,032
Expenses Total		33,157,969

**UNFUNDED and FUTURE PROJECT
Parks, Trails, & Open Space**

723500: Arts Center

Description: This project will enhance the Arts Center to provide more positive recreational activities, visual interest and increase park usage. The Arts Center site is evolving into a destination for Downtown Gresham. The inter-active fountain has been designed for safety, aesthetics, sustainability, cost and theme. The fountain compliments the existing colored pavement lights and recent art pillar installations. The project is located in the Central City Neighborhood District.

Justification: The center will provide customer service by helping meet the program needs of seniors, adults, teens, school-age, pre-school, families with disabilities, and diverse cultural groups. The center will also help direct the city's youth toward positive activities. Development is needed to provide a wide range of recreation opportunities for all Gresham residents.

Type of Project: Construction of facilities and utilities for growth.

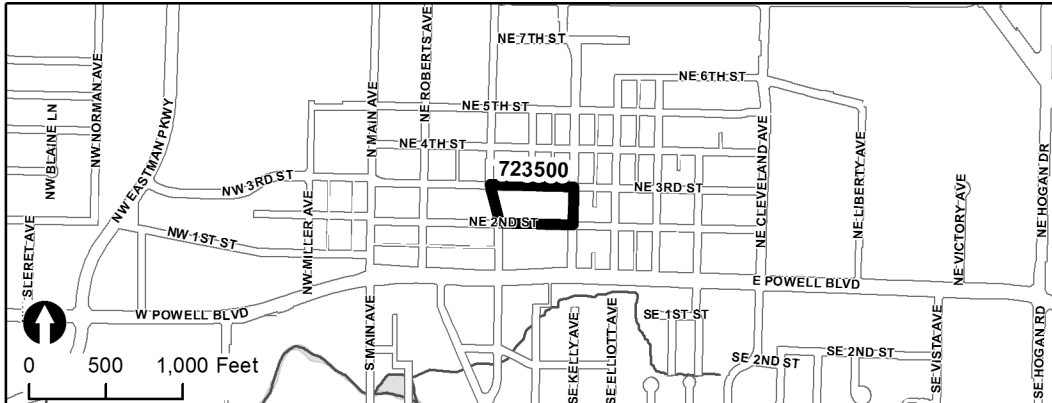

Estimated Dollars:

Funds	Description	Total
Resources	Other	16,480,000
Resources Total		16,480,000
Expenses	Design/Const Admin	1,648,000
	Construction	12,524,800
	Admin (14%)	2,307,200
Expenses Total		16,480,000

**UNFUNDED and FUTURE PROJECT
Parks, Trails, & Open Space**

723600: SE Community Park Development

Description: This project will construct recreation facilities identified in the master plan for the 16.13-acre undeveloped community park in southeast Gresham. The project is located in the Kelly Creek Neighborhood District. The project is related to #703200. SDC project #4.

Justification: Development of this community park is needed to provide a wide range of active and passive recreation opportunities for all Gresham residents.

Type of Project: Construction of facilities and utilities for growth.

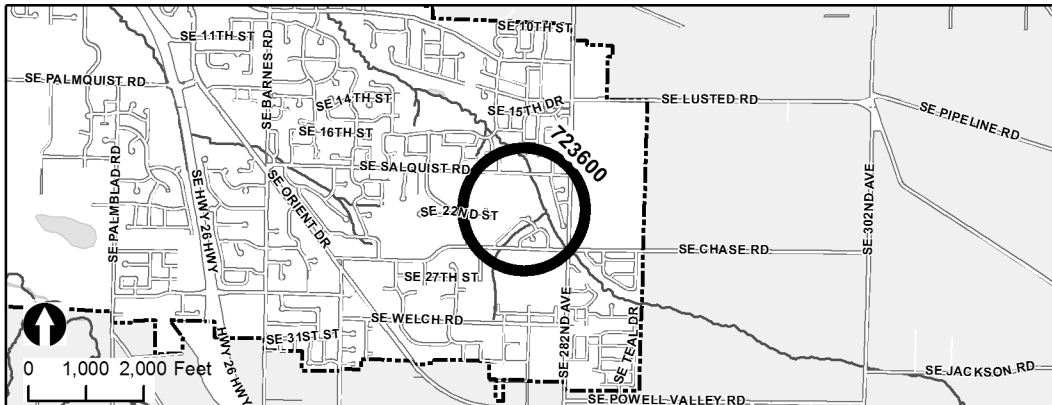

Estimated Dollars:

Funds	Description	Total
Resources	Other	5,149,946
	SDC	4,053,710
Resources Total		9,203,656
Expenses	Design/Const Admi	314,968
	Construction	7,758,414
	Admin (14%)	1,130,274
Expenses Total		9,203,656

**UNFUNDED and FUTURE PROJECT
Parks, Trails, & Open Space**

723700: Main City Park Improvements Future

Description: This project will renovate and enhance Main City Park to accommodate community-wide events. Due to the park location as a designated regional town center and relationship with the regional Springwater Trail, Main City Park is being repositioned to become the flagship community park of Gresham. The central core of the park will be reconfigured, removing parking with replacement of a focal-point Destination Playground. The playground will be designed for safety, aesthetics, cost and theme. The Destination Playground will include play elements for children 2-5, 5- 12 and a decorative, inter-active water feature. There is an additional resource need to complete the plan improvements that will also include an improved group picnic area; renovated ball fields, basketball courts, and horseshoe pits; bocche and croquet fields; entry plaza; off-lease dog park; amphitheater; meadows and environmental enhancement of Johnson Creek. Main City Park is located in the Central City and Gresham Butte Neighborhood Districts. SDC project #67.

Justification: Development is needed to provide a wide range of recreation opportunities for all Gresham residents.

Type of Project: Expansion of community park facilities for growth.

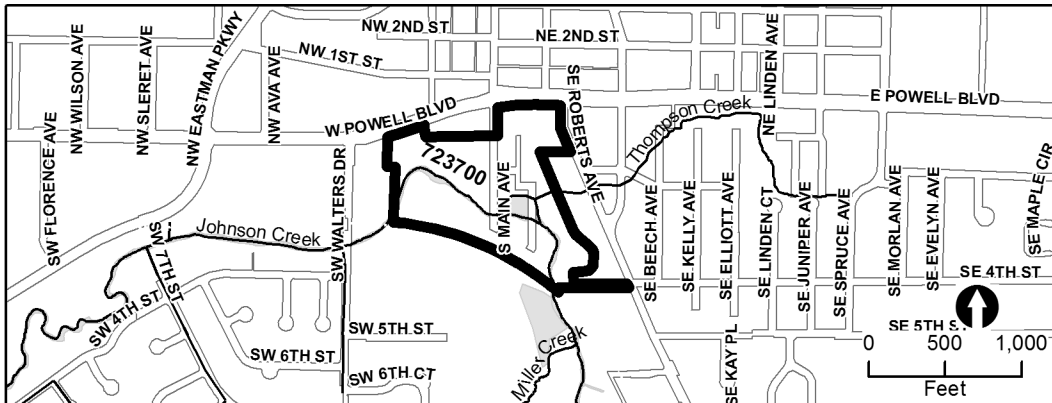

Estimated Dollars:

Funds	Description	Total
Resources	Other	8,794,538
	SDC	593,112
Resources Total		9,387,650
Expenses	Design/Const Admi	717,557
	Construction	7,517,224
	Admin (14%)	1,152,869
Expenses Total		9,387,650

**UNFUNDED and FUTURE PROJECT
Parks, Trails, & Open Space**

723800: Hogan Butte Nature Park Development – Phase 2

Description: This project will design and construct the second phase of the 52.02-acre nature park and viewpoint in south Gresham in keeping with the 2008 Hogan Butte Nature Park Master Plan. The project is located in the Gresham Butte Neighborhood District. SDC project #3.

Justification: The project provides passive recreation facilities for the community to view five Cascade Mountains and to learn why park and open space land needs to be acquired and preserved/protected or developed to provide recreation opportunities for the community.

Type of Project: Design and construction of community park facilities for growth.

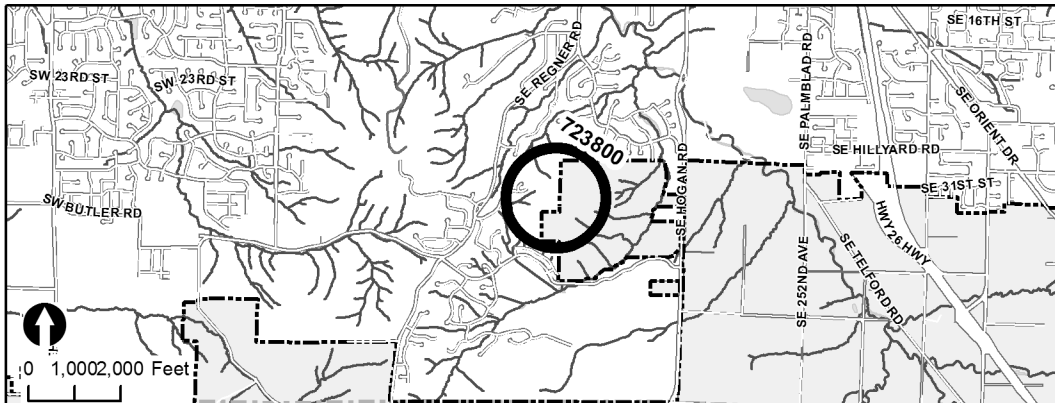

Estimated Dollars:

Funds	Description	Total
Resources	Other	2,351,099
	SDC	1,406,918
Resources Total		3,758,017
Expenses	Design/Const Admi	609,923
	Construction	2,686,583
	Admin (14%)	461,511
Expenses Total		3,758,017

**UNFUNDED and FUTURE PROJECT
Parks, Trails, & Open Space**

724700: Civic Neighborhood Station Plaza

Description: This project will master plan, design and construct a 1-acre plaza on Metro owned property north of the Civic Drive Max Station to serve the surrounding neighborhood. This project is located in the Northwest Neighborhood District. “Other” funding could be options such as: developer contribution, Metro contribution, or a state grant to be determined at a later date. SDC project #2.

Justification: Development is needed to provide a neighborhood urban space for events and passive recreation.

Type of Project: Master plan, design and construction of a neighborhood plaza for growth.

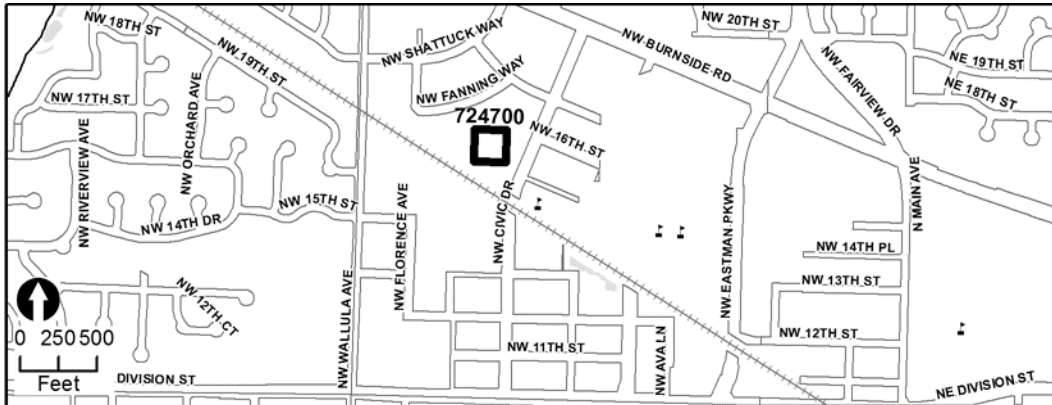

Estimated Dollars:

Funds	Description	Total
Resources	Other	783,714
	Dev/SDC Credit	562,888
Resources Total		1,346,602
Expenses	Design/Const Admi	92,660
	Construction	1,088,584
	Admin (14%)	165,358
Expenses Total		1,346,602

**UNFUNDED and FUTURE PROJECT
Parks, Trails, & Open Space**

724800: Nadaka Nature Park

Description: This project will design and construct a new or expanded children’s play area and affiliated improvements. The project is located in the Wilkes East Neighborhood District. SDC project #73.

Justification: Expansion of this park is needed to provide a wide range of active and passive recreation opportunities for citizens at their nearby neighborhood park.

Type of Project: Design and construction of neighborhood park facilities for growth.

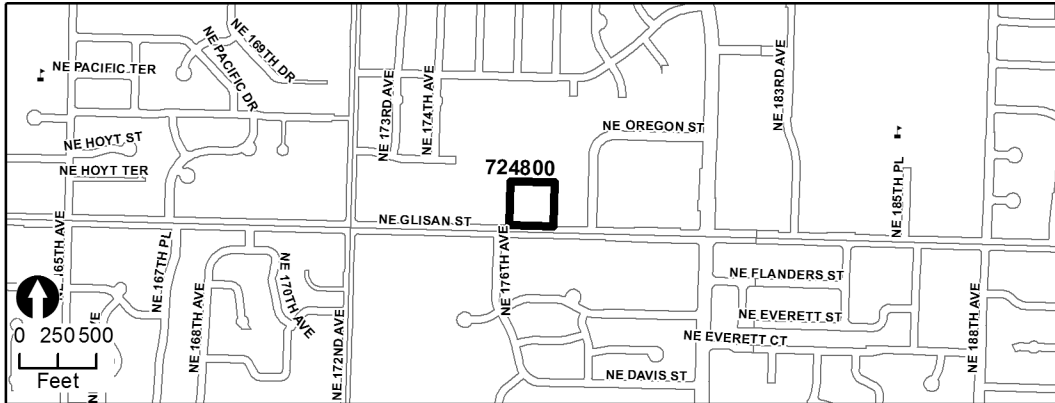

Estimated Dollars:

Funds	Description	Total
Resources	Other	21,871
	SDC	15,708
Resources Total		37,579
Expenses	Design/Const Admi	12,527
	Construction	20,437
	Admin (14%)	4,615
Expenses Total		37,579

**UNFUNDED and FUTURE PROJECT
Parks, Trails, & Open Space**

724900: Columbia View Neighborhood Park

Description: This project will design and construct a 7.46-acre neighborhood park at this unimproved site. The master plan for this park was adopted in 1988 and will likely need to be modified to meet the desires of the surrounding neighborhood. The project is located in the Wilkes East Neighborhood District. This project is related to #711200. SDC project #69.

Justification: Development is needed to provide a wide range of active and passive recreation opportunities for citizens at their nearby neighborhood park.

Type of Project: Design and construction of neighborhood park facilities for growth.

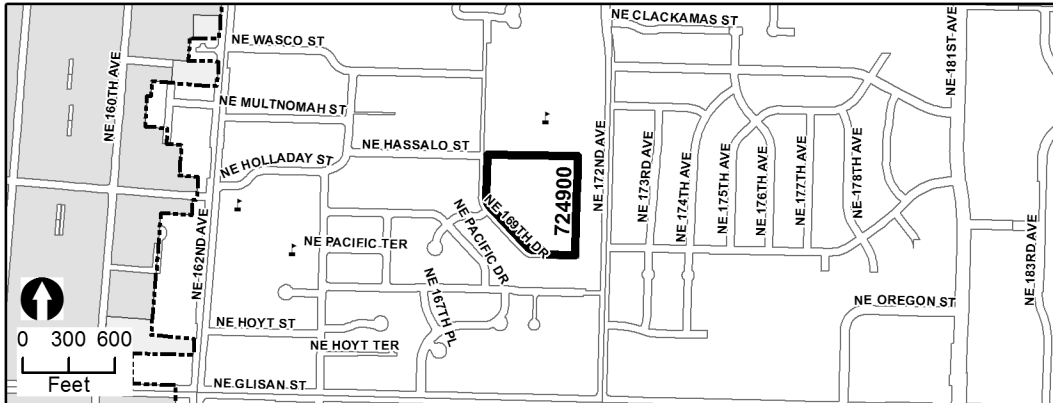

Estimated Dollars:

Funds	Description	Total
Resources	Other	2,790,606
	SDC	2,004,296
Resources Total		4,794,902
Expenses	Design/Const Admi	125,265
	Construction	4,080,790
	Admin (14%)	588,847
Expenses Total		4,794,902

**UNFUNDED and FUTURE PROJECT
Parks, Trails, & Open Space**

725000: Civic Neighborhood Park Phase 2

Description: This project constructs the second phase of the approximately 2-acre neighborhood park in the Civic Neighborhood Plan Area. The project is located in the Northwest Neighborhood District. This project is related to # CIPPK00005 and #CIPPKNEW02.

Justification: Development is needed to provide a wide range of active and passive recreation opportunities for citizens at their nearby neighborhood park.

Type of Project: Construction of neighborhood park facilities for growth.

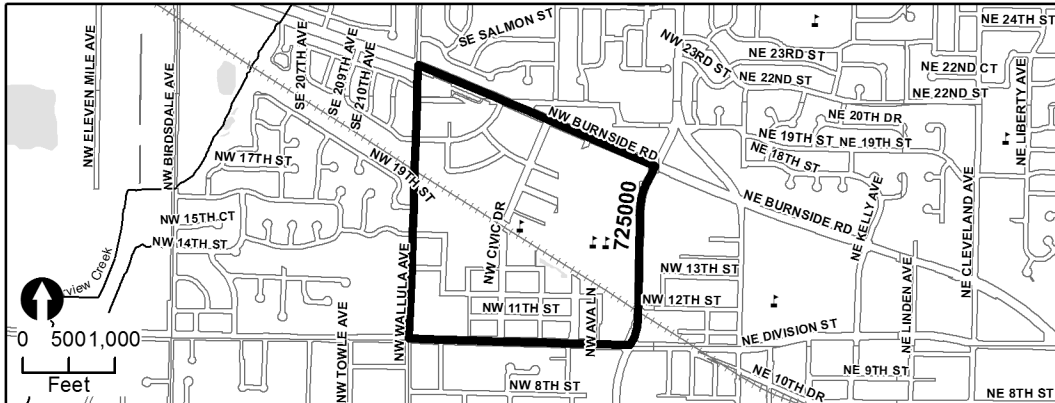

Estimated Dollars:

Funds	Description	Total
Resources	Other	1,221,137
	SDC	2,881,301
Resources Total		4,102,438
Expenses	Design/Const Admi	93,949
	Property Acq	2,004,244
	Construction	1,500,437
	Admin (14%)	503,808
Expenses Total		4,102,438

**UNFUNDED and FUTURE PROJECT
Parks, Trails, & Open Space**

725100: Rockwood Soccer/Futsal Courts

Description: This project will design and construct soccer or futsal courts in City park or open space land in the Rockwood Plan District. SDC project #74.

Justification: Development is needed to provide a wide range of active and passive recreation opportunities for citizens.

Type of Project: Design and construction of park facilities for growth.

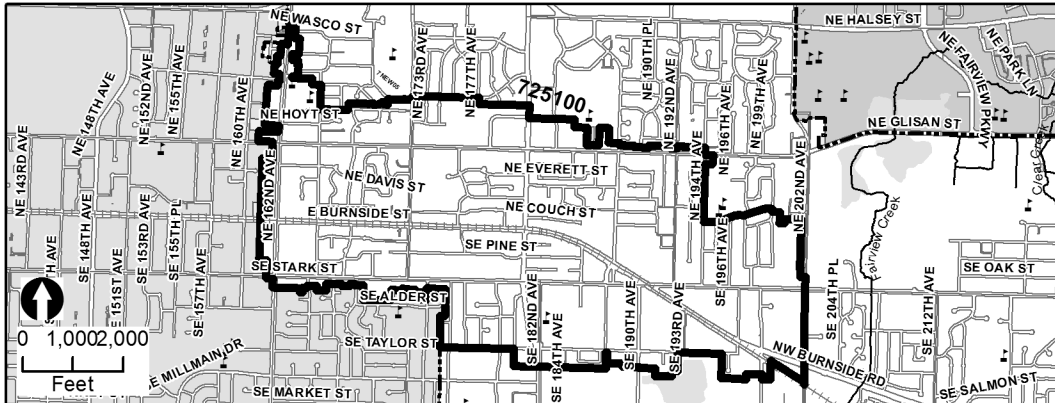

Estimated Dollars:

Funds	Description	Total
Resources	Other	116,646
	SDC	83,779
Resources Total		200,425
Expenses	Design/Const Admi	12,527
	Construction	163,283
	Admin (14%)	24,615
Expenses Total		200,425

**UNFUNDED and FUTURE PROJECT
Parks, Trails, & Open Space**

725200: Downtown Neighborhood Park #2 - East

Description: This project will acquire land, master plan, design and construct an approximately 2-acre neighborhood park in the Downtown boundary east of Kelly Avenue. This project is located in the Central City Neighborhood District. SDC project #16.

Justification: Development is needed to provide a wide range of active and passive recreation opportunities for citizens at their nearby neighborhood park.

Type of Project: Acquisition, master plan, design and construction of a neighborhood park for growth.

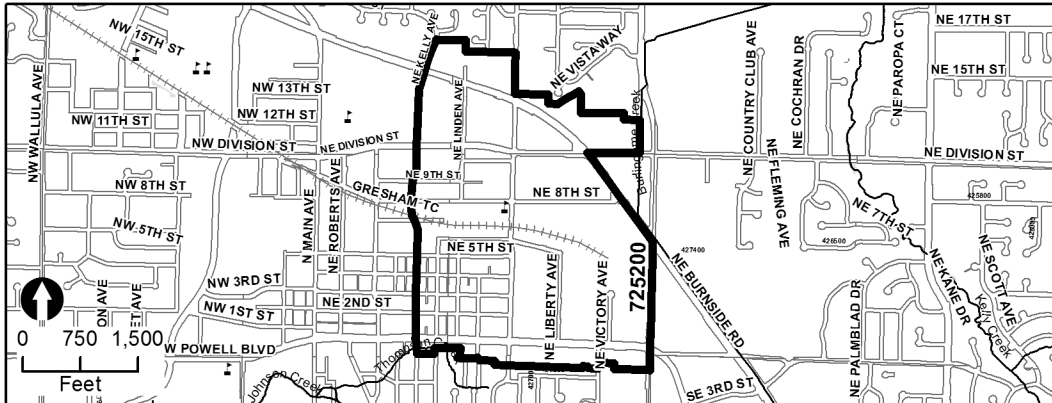

Estimated Dollars:

Funds	Description	Total
Resources	Other	1,221,137
	SDC	2,881,301
Resources Total		4,102,438
Expenses	Design/Const Admi	93,949
	Property Acq	2,004,244
	Construction	1,500,437
	Admin (14%)	503,808
Expenses Total		4,102,438

**UNFUNDED and FUTURE PROJECT
Parks, Trails, & Open Space**

CIPPK00002: Vance Neighborhood Park

Description: This project will design and construct a parking area and associated improvements within Vance Neighborhood Park, currently owned by Multnomah County. This project is located in the Rockwood Neighborhood. SDC project #75.

Justification: Addition of a parking lot would make it more convenient and safer for residents to access this neighborhood park.

Type of project: Design and construction of additional neighborhood park facilities for growth.

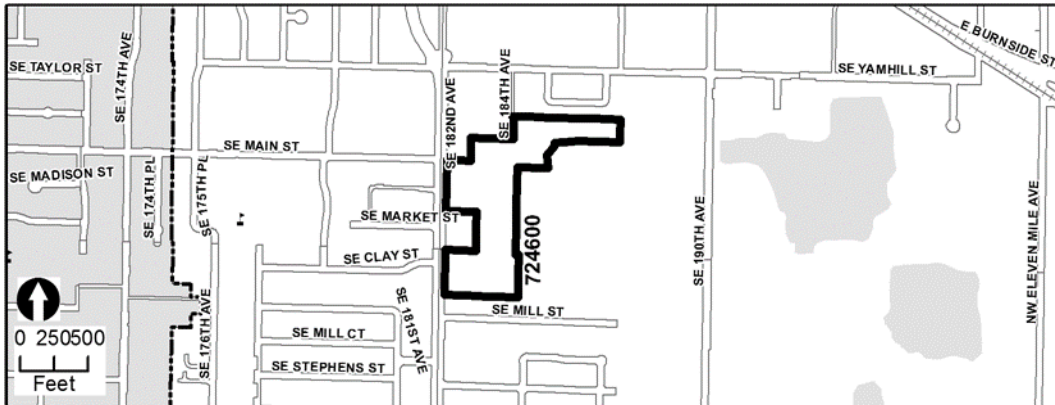

Estimated Dollars:

Funds	Description	Total
Resources	Other	100,000
	SDC	50,000
Resources Total		150,000
Expenses	Design/Const Admi	15,000
	Construction	116,600
	Admin (14%)	18,400
Expenses Total		150,000

**UNFUNDED and FUTURE PROJECT
Parks, Trails, & Open Space**

CIPPK00005: Civic Neighborhood Development - 1996 Agreement

Description: This project reflects the City’s potential obligation as described in the 1996 Gresham Civic Neighborhood Financing Agreement (City Agreement 1996-083) to reimburse a developer for construction of park infrastructure related to the Civic Neighborhood Project. The project is located in the Northwest Neighborhood District. SDC project #76.

Justification: City financial support is needed to support the innovative objectives of the Civic Neighborhood Development Plan.

Type of project: Construction of utilities and facilities for growth.



Estimated Dollars:

Funds	Description	Total
Resources	SDC	799,700
Resources Total		799,700
Expenses	Construct/Reimburse	799,700
Expenses Total		799,700

CITY OF
GRESHAM
OREGON